

■ Features

- ★ Precise tolerance and stability
- ★ Ultra low height
- ★ 4 Pads
- ★ Ceramic lid and base

■ Application

- ★ Cellular phones
- ★ Cordless telephones
- ★ PHS
- ★ Pagers

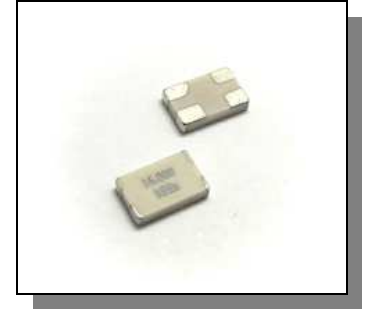

■ Specification (Characteristics)

| Item | Specification |
|-------------------------------|-------------------|
| Oscillate Frequency (MHz) | 10.000 ~ 36.000 |
| Resonance Mode | Fundamental |
| Load Capacitance (pF) | 8, 12, 16, 20, 32 |
| Frequency Tolerance max (ppm) | ±30, ±50 |
| Resonant Impedance max (Ω) | See Table 1 |
| Static Capacitance max (pF) | 7 |
| Operating Temperature (°C) | -10~+70 |
| Frequency Stability (ppm) | ±30, ±50 |
| Operating drive level (mW) | 0.1 |
| Aging max (ppm / year) | ±5 (at 25±2°C) |

■ Dimension (Unit: mm)

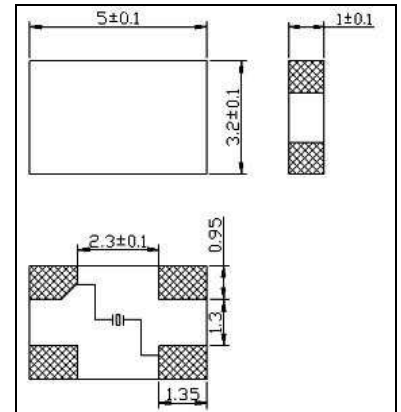

■ Recommended Soldering

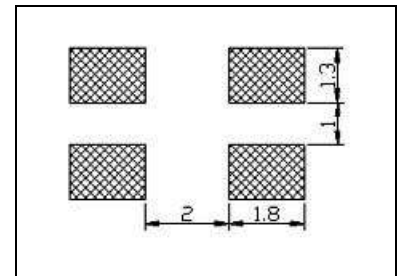

■ Table 1

| Frequency Range(MHz) | ESR (Ω) | Mode |
|----------------------|---------|-------|
| 10.000 ~ 11.999 | 120 | Fund. |
| 12.000 ~ 14.399 | 80 | Fund. |
| 14.400 ~ 36.000 | 50 | Fund. |

■ Part Number and Ordering

| Part Number Code | Holder Type + Frequency + Mode of vibration + Tolerance/ Stability + RS + CL |
|------------------|---|
| Ordering Code | Same as Above |
| Example | C5032(4)-12M-AF-30/50-80Ω-20P |